

PISA

COLLECTION



Day and Night



PISA

COLLECTION

DAY

DINING ROOM	02
ENTERTAINMENT CENTER	04
TV BASE / OCCASIONAL TABLES	05

NIGHT

BEDROOM	8
---------	---







PISA DINING ROOM IN WALNUT CANALETTO-ZEBRANO HIGH GLOSS



4/D BUFFET KJPI610CN
With 2 wood shelves and cutlery drawer

inch	W 67"	D 22"	H 33"
cm	L 169	P 55	H 85
Crts	1	kg 97	m ³ 0,98



EXTEN. DINING TABLE PJPI0615CN
With 2 leaves: W 117", cm 295 (1 leaf 18", cm 45)

inch	W 81/117"	D 41"	H 31"
cm	L 205/295	P 105	H 78
Crts	2	kg 120	m ³ 0,41

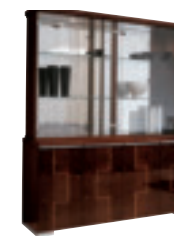

USA 4/D CHINA CABINET (110V) PJPI0600CN
UK 4/D CHINA CABINET (220V) PJPI0601CN
With 2 glass shelves, 2 wood shelves, 2 lights and cutlery drawer

inch	W 66"	D 22"	H 82"
cm	L 167	P 55	H 209
Crts	3	kg 194	m ³ 2,04



USA 2/D CURIO (110V) PJCA0605CN
UK 2/D CURIO (220V) PJCA0607CN
With 3 glass shelves, 1 light

inch	W 38"	D 20"	H 71"
cm	L 97	P 50	H 180,5
Crts	2	kg 120	m ³ 1,18



MIRROR KJPI140CN

inch	W 45"	D 1"	H 42"
cm	L 114	P 2,8	H 106,2
Crts	1	kg 28	m ³ 0,09



2 ARMCHAIRS KJPI622CN
2 ARMCHAIRS (UK) KJPI622CNI
With wood back panel and upholstered microfibre seat

inch	W 24"	D 23"	H 43"
cm	L 60	P 59	H 108
Crts	1	kg 19	m ³ 0,58



2 SIDE CHAIRS KJPI620CN
2 SIDE CHAIRS (UK) KJPI620CNI
With wood back panel and upholstered microfibre seat

inch	W 21"	D 23"	H 43"
cm	L 53	P 59	H 108
Crts	1	kg 17	m ³ 0,44



ENTERT. CENTER PJPI0633CN
With 2 doors sliding base, 1 door column, shelves

inch	W 73"	D 21"	H 70"
cm	L 185	P 54	H 177
Crts	3	kg 168	m ³ 0,99



BASE ONLY KJPI629CN
With 2 doors sliding

inch	W 73"	D 22"	H 20"
cm	L 185	P 54	H 52
Crts	1	kg 93	m ³ 0,64



TV BASE KJPI612CN
With 3 doors and open unit

inch	W 67"	D 19"	H 27"
cm	L 168,7	P 48	H 66,5
Crts	3	kg 168	m ³ 0,99



LAMP TABLE PJPI0625CN

inch	W 28"	D 28"	H 21"
cm	L 70	P 70	H 54,5
Crts	2	kg 31	m ³ 0,09



SQUARE COCKTAIL TABLE PJPI0626CN

inch	W 39"	D 39"	H 16"
cm	L 100	P 100	H 40,5
Crts	2	kg 50	m ³ 0,13



RECTANGULAR TABLE PJPI0627CN

inch	W 53"	D 28"	H 16"
cm	L 135	P 70	H 40,5
Crts	2	kg 51	m ³ 0,12



SOFA TABLE PJPI0628CN

inch	W 53"	D 17"	H 28"
cm	L 135	P 43	H 70
Crts	2	kg 57	m ³ 0,1





PISA BEDROOM IN WALNUT CANALETTO-ZEBRANO HIGH GLOSS



6/DRW. DRESSER KJP1120CN
With 6 drawers

inch	W 69"	D 20"	H 32"
cm	L 174	P 51	H 81,6
Crts	1	kg 97	m ³ 0,91



NIGHT STAND KJP1130CN
With 2 drawers

inch	W 30"	D 17"	H 23"
cm	L 75	P 44	H 57,2
Crts	1	kg 37	m ³ 0,26

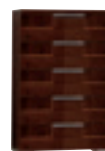

5/DRW. CHEST KJP1115CN
With 5 drawers

inch	W 39"	D 20"	H 56"
cm	L 98	P 51	H 142,8
Crts	1	kg 90	m ³ 0,87



MIRROR KJP1140CN

inch	W 45"	D 1"	H 42"
cm	L 114	P 2,8	H 106,2
Crts	1	kg 28	m ³ 0,09



Q.S./UK 5" BED PJPI0150CN
Inner size inch 61 1/2" x 81 1/2"

	cm 157 x 207		
inch	W 70"	D 91"	H 52"
cm	L 178	P 230	H 133
Crts	3	kg 106	m ³ 0,37

K.S./UK 6.6" BED PJPI0175CN
Inner size inch 76 3/4" x 81 1/2"

	cm 195 x 207		
inch	W 85"	D 91"	H 52"
cm	L 216	P 230	H 133
Crts	3	kg 118	m ³ 0,43

UK 6" BED PJPI0184CN
Inner size inch 73 1/2" x 81 1/2"

	cm 187 x 207		
inch	W 85"	D 95"	H 52"
cm	L 216	P 241	H 133
Crts	3	kg 120	m ³ 0,43

CALIFORNIA BED PJPI0185CN
Inner size inch 73 1/2" x 85 3/4"

	cm 187 x 218		
inch	W 85"	D 95"	H 52"
cm	L 216	P 241	H 133
Crts	3	kg 120	m ³ 0,43

PISA COLLECTION

design
c.r.s. ALF

photo
c.r.s. ALF

selection
Fotolito Maistri

print
OGM



A.L.F. UNO S.P.A. is certified by the ISO 9001:2008

Our furniture finishes are mainly UV-based. All our furniture board is within the E1 norm for formaldehyde emission. By using UV-based finish the formaldehyde is sealed within the furniture board keeping emissions to an absolute minimum.

ATTENTION: PRODUCT APPEARANCE, SIZE, AND/OR MATERIALS MAY BE SUBJECT TO CHANGE WITHOUT NOTICE

pisa

collection



HOME OFFICE







The interior space of the Credenza's two drawers can be "organized" as desired thanks to adjustable partitions.



3







7

The "Home Office" collection offers a series of useful features to optimize your working space.



PISA HOME OFFICE IN WALNUT CANALETTO-ZEBRANO HIGH GLOSS

COMPOSITION EXAMPLES:



CREDENZA HUTCH W. 180 PJPI0750CN
With wireway

inch W 71" D 15" H 54"
cm L 180 P 36 H 137
Crts 3 kg 86 m³ 0,300



FILE CABINET HUTCH W. 90 PJPI0760CN
With wireway and adjustable shelves

inch W 36" D 15" H 54"
cm L 90 P 36 H 137
Crts 1 kg 45 m³ 0,164



LIBRARY BOOKCASE PJPI0770CN
With adjustable shelves

inch W 40" D 15" H 84"
cm L 100 P 36 H 213
Crts 2 kg 74 m³ 0,260

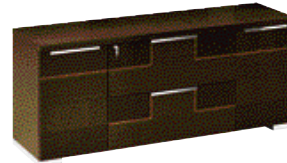

CREDENZA W. 180 KJPI700CN
With 2 doors and 2 large drawers
featuring adjustable feet levellers

inch W 71" D 21" H 30"
cm L 180 P 51 H 76
Crts 1 kg 100 m³ 0,868



FILE CABINET W. 90 KJPI710CN
With 2 large drawers
featuring adjustable feet levellers

inch W 36" D 21" H 30"
cm L 90 P 51 H 76
Crts 1 kg 56 m³ 0,448



PEDESTAL WITH WHEELS KJPI720CN
With 1 drawer and 1 big drawer

inch W 19" D 18" H 25"
cm L 47 P 44,5 H 61,6
Crts 1 kg 36 m³ 0,158



PEDESTAL WITH FEET KJPI730CN
With 2 drawers and 1 big drawer
featuring adjustable feet levellers

inch W 19" D 18" H 28"
cm L 47 P 44,5 H 70,5
Crts 1 kg 31 m³ 0,202



DESK W. 180 KJPI780CN
With 2 wireways
featuring adjustable feet levellers

inch W 71" D 34" H 30"
cm L 180 P 86 H 76
Crts 1 kg 83 m³ 0,289



DESK W. 160 KJPI782CN
featuring adjustable feet levellers

inch W 63" D 25" H 30"
cm L 160 P 61 H 76
Crts 1 kg 60 m³ 0,191



DESK W. 120 KJPI784CN
featuring adjustable feet levellers

inch W 48" D 25" H 30"
cm L 120 P 61 H 76
Crts 1 kg 50 m³ 0,171



RETURN DESK W. 120 KJPI786CN
featuring adjustable feet levellers

inch W 48" D 25" H 30"
cm L 120 P 61 H 76
Crts 1 kg 45 m³ 0,171



FLÓ CHAIR FLO_B/FLO_W

Metal structure and white or black
ecoleather seat and back
inch W 23" D 21" H 34"
cm L 58 P 54 H 85,5
Crts 1 kg 15 m³ 0,16

**ADDITIONAL SHELF FOR LIBRARY
CABINET HUTCH** KJPI773CN

inch W 38" D 14" H 1"
cm L 95 P 34 H 2,5
Crts 1 kg 5 m³ 0,022

**ADDITIONAL SHELF FOR FILE
CABINET HUTCH** KJPI763CN

inch W 34" D 14" H 1"
cm L 85 P 34 H 2,5
Crts 1 kg 5 m³ 0,020

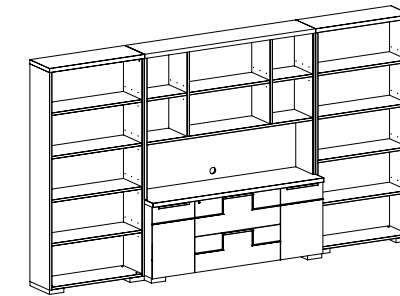

LIBRARY COMPOSITION 1 PJPI0800CN

inch W 150" D 21" H 84"
cm L 380 P 51 H 213
Crts 8 kg 334 m³ 1,688

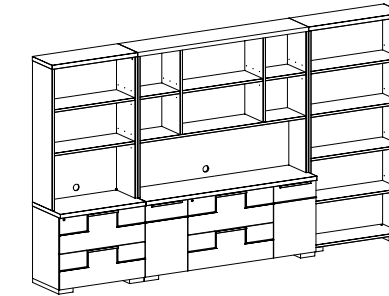

LIBRARY COMPOSITION 2 PJPI0801CN

inch W 146" D 21" H 84"
cm L 370 P 51 H 213
Crts 8 kg 361 m³ 2,040

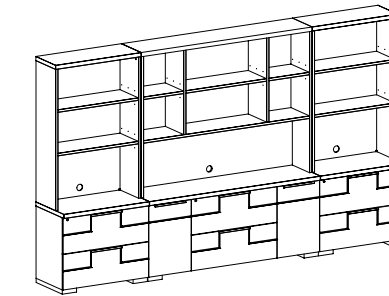

LIBRARY COMPOSITION 3 PJPI0802CN

inch W 111" D 21" H 84"
cm L 280 P 51 H 213
Crts 8 kg 388 m³ 2,392

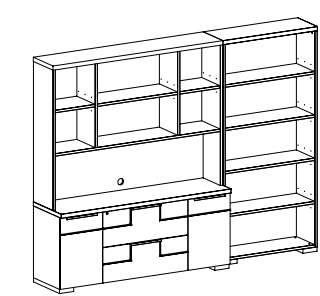

LIBRARY COMPOSITION 4 PJPI0803CN

inch W 111" D 21" H 84"
cm L 280 P 51 H 213
Crts 6 kg 260 m³ 1,428

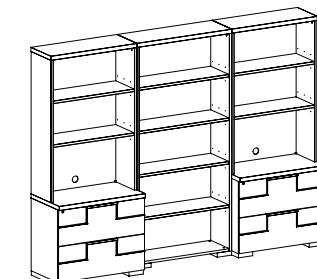

LIBRARY COMPOSITION 5 PJPI0804CN

inch W 111" D 21" H 84"
cm L 280 P 51 H 213
Crts 6 kg 276 m³ 1,484

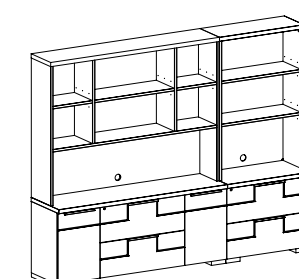

LIBRARY COMPOSITION 6 PJPI0805CN

inch W 111" D 21" H 84"
cm L 280 P 51 H 213
Crts 6 kg 287 m³ 1,780

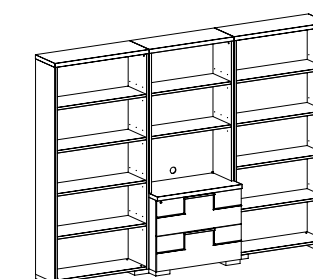

LIBRARY COMPOSITION 7 PJPI0806CN

inch W 115" D 21" H 84"
cm L 290 P 51 H 213
Crts 6 kg 249 m³ 1,132

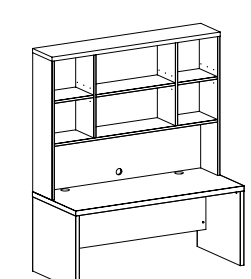

LIBRARY COMPOSITION 8 PJPI0810CN

inch W 71" D 34" H 83"
cm L 180 P 86 H 210
Crts 4 kg 169 m³ 0,589

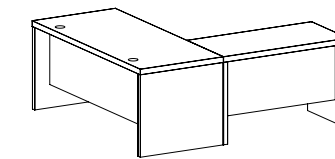

DESK COMPOSITION 1 PJPI0807CN
Desk + Return desk

inch W 71" D 82" H 30"
cm L 180 P 206 H 76
Crts 2 kg 128 m³ 0,460

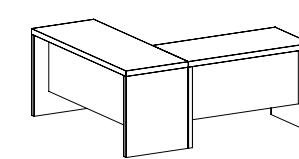

DESK COMPOSITION 2 PJPI0808CN
Desk + Return desk

inch W 63" D 72" H 30"
cm L 160 P 181 H 76
Crts 2 kg 105 m³ 0,362

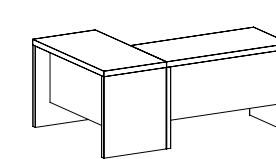

DESK COMPOSITION 3 PJPI0809CN
Desk + Return desk

inch W 48" D 72" H 30"
cm L 120 P 181 H 76
Crts 2 kg 95 m³ 0,342

home
office

design
Alf c.r.s.

photo
STEP

selection
Fotolito Maistri

print
OGM



A.L.F. UNO S.P.A. is certified by the ISO 9001:2008

Our furniture finishes are mainly UV-based. All our furniture board is within the E1 norm for formaldehyde emission. By using UV-based finish the formaldehyde is sealed within the furniture board keeping emissions to an absolute minimum.

ATTENTION: PRODUCT APPEARANCE, SIZE, AND/OR MATERIALS MAY BE SUBJECT TO CHANGE WITHOUT NOTICE

CANADA & USA NORTH-EAST COAST
TEL. (416) 663-2223 - FAX (416) 663-2594
E-MAIL: alf@rosnerinternational.com

CENTRAL AMERICA - CARIBBEAN ISLANDS
TEL. (787) 786-9705 - FAX (787) 785-9835
E-MAIL: alvin@arodz.net

LOUISIANA-OKLAHOMA-TEXAS
TEL. (405) 204-4737
E-MAIL: parke9094@att.net

COLORADO-NEW MEXICO-UTAH
E-MAIL: alf@alf.it

FLORIDA
TEL. (561) 212-5676 - FAX (561) 997-9169
E-MAIL: hollister@bellsouth.net

MID-WEST/SOUTH-EAST (EXCLUDING FLORIDA)
TEL. (310) 636-1199 - FAX (310) 636-4433
E-MAIL: wrw@whitehalldesigns.com

U.S.A. - HIGH POINT SHOWROOM
(OPEN ONLY DURING FURNITURE MARKET DATES)
TEL. (336) 889-9027 - FAX (336) 889-9079

WESTERN U.S.A. - HAWAII
TEL. (949) 374-2900 - FAX (949) 364-3822
E-MAIL: alfwesternusa@aol.com

AUSTRALIA & NEW ZEALAND
TEL. (08) 9314-3999 - FAX (08) 9314-3777
E-MAIL: ross@merlino.com.au

MEXICO
TEL. +39 3401596793 - FAX +39 0438997246
E-MAIL: giulio.botteon@italfurniture.it

AUSTRIA
E-MAIL: alf@alf.it

GERMANY
TEL. 0049 2536343450 - FAX 0049 2536343456
E-MAIL: info@magenta-vertrieb.de

SWITZERLAND
TEL. 0041 523661277
TEL. 0041 784174344 E-MAIL: marcopetix@gmx.ch
TEL. 0041 794048941 E-MAIL: spetix@gmx.ch

BELGIQUE
TEL. 0032497526746 - FAX 0032497526746
E-MAIL: stephane.porignon@telenet.be

DENMARK
TEL. +45 20475875
E-MAIL: lehri@mail.dk

EAST EUROPE
TEL. +39 3484064921
E-MAIL: caputomauro@libero.it
HUNGARY: johns@johns.hu
CZECH-SLOVAK: infinity.prague@volny.cz

U.K.
TEL. +44 1565631077 - FAX +44 1565621436
E-MAIL: tim@3dpartnership.com
andrew@3dpartnership.com - jt@3dpartnership.com

FRANCE - BRETAGNE - NORMANDIE - CENTRE
TEL. 0033608423974
E-MAIL: contact@jmcscarl.fr

FRANCE - EST
TEL. 0033615436985
E-MAIL: ch.vidrin@wanadoo.fr

FRANCE - SUD-EST
TEL. 33651330596 - FAX 33958730003
E-MAIL: albouy@sanitairediffusion.fr

FRANCE - ILE DE FRANCE
TEL. 0033609810991
E-MAIL: catherinepouette@wanadoo.fr

FRANCE - NORD
TEL. 0033660816585
E-MAIL: treuil.pa@wanadoo.fr

FRANCE - SUD-OUEST
TEL. 0033686088876 - FAX 0033553289387
E-MAIL: fabien.herbette@hotmail.fr

FRANCE - RHONE/ALPES
TEL. 0033689923725 - FAX 003346677294
E-MAIL: fredericc.ac@orange.fr

HELLAS-CYPRUS
TEL. +39 0434 77199 - FAX +39 0434 779591
E-MAIL: info@cfsolution.it

INDIA-SRI LANKA
TEL. +91 8041285290 - 91 9845636644
E-MAIL: keith@kreb.in

MIDDLE-EAST AND THE GULF REGION
TEL. +961 4718160 - FAX +961 4718159
E-MAIL: info@furniture-line.com

POLAND
TEL. +48 618175994 - FAX +48 616429218
E-MAIL: karina@qualitaliana.pl

CSI E PAESI BALTICI
TEL. +7-812-3322994 - FAX +7-812-3322934
E-MAIL: office.spb@alf.it

SOUTH AFRICA
TEL. +27 823225215 - FAX +27 865018307
E-MAIL: clint@furntec.co.za

SPAIN - ANDALUCIA Y EXTREMADURA
TEL. +34 958818744 - FAX +34 958302251
E-MAIL: info@javiercastellon.com

SPAIN - ARAGÓN, SORIA, LA RIOJA, NAVARRA Y PAIS VASCO
TEL. +34 976227321 - FAX +34 976227321
E-MAIL: repres_cramon@yahoo.es

SPAIN - ASTURIAS Y CANTABRIA
TEL. +34 609 803 348 - FAX +34 985 894 580
E-MAIL: geliquintueles@yahoo.es

SPAIN - CASTILLA Y LEON
TEL. +34983541003 - FAX +34983541003
E-MAIL: evaristorg@gmail.com

SPAIN - BARCELONA - CATALUNYA Y ANDORRA
TEL. +34 935531590 - FAX +34 935531590
E-MAIL: albert-miro-mauri@hotmail.com

SPAIN - CATALUNYA Y ANDORRA
TEL. +34 93 718 37 97 - FAX +34 93 718 37 97
E-MAIL: pepauge@hotmail.com

SPAIN - MALLORCA, MENORCA, IBIZA, FORMENTERA
TEL. +34971434088 - FAX +34971434088
E-MAIL: lbonnin@cgac.es

SPAIN - VALENCIA, MURCIA Y CASTILLA LA MANCHA
TEL. +34 607 210 185
E-MAIL: joseluis@nexus-jlh.com

TURKEY
TEL. +90 3128475080 - FAX +90 3128475280
E-MAIL: casa@casa.com.tr



A.L.F. UNO S.P.A.

VIA S. PIO X, 17 31018 FRANZENIGO DI GAIARINE (TV) ITALY

TEL. +39-0438 997 111 FAX +39-0438 997 246

alf@alf.it www.alfitalia.com